



Packed full of power

- **Reliable heavy-duty German engine** for maximum efficiency
- **Suitable for large pools**, up to 140 m³
- Union fitting kit for easy **installation and maintenance**
- Extra-wide strainer basket (2,950 cm³) to reduce cleaning frequency
- **Transparent strainer basket** for easy maintenance
- **A 3 HP RS II can treat a pool of up to 140 m³**

YEARS OF WARRANTY

CONFIG



<http://www.hayward-pool.co.uk/services/toolbox>

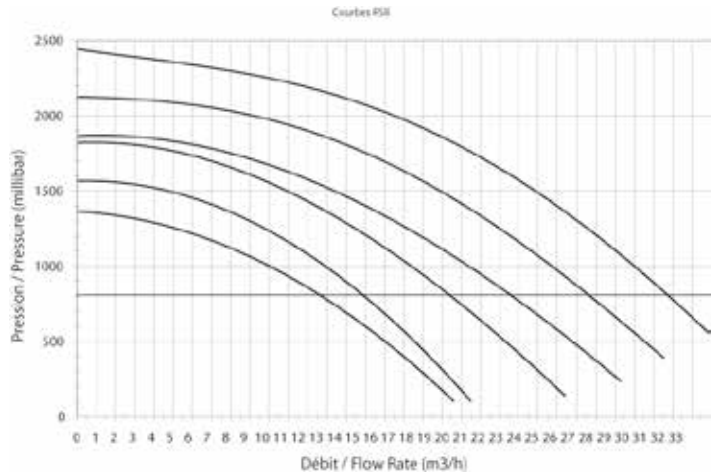
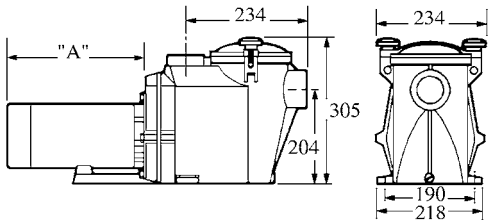

RS II

	Power	Watt	Flow Rate*	Side A	I/O	Weight	Max. consumption	Amperage	Ref
RS II SINGLE-PHASE	3/4 cv	0,55 Kw	12,5 m ³ /h	213 mm	63 mm	12 kg	870 W	3,6	RS30081
	1 cv	0,75 Kw	15 m ³ /h	213 mm	63 mm	15 kg	975 W	4,3	RS30111
	1,5 cv	1,1 Kw	19,5 m ³ /h	225 mm	63 mm	16 kg	1 100 W	5	RS30161
RS II THREE PHASE	2 cv	0,75 Kw	20,5 m ³ /h	230 mm	63 mm	16 kg	1 500 W	7,25	RS30201
	2 cv	1,5 Kw	22,5 m ³ /h	230 mm	63 mm	16 kg	1 500 W	5,2 / 3,0	RS30203
	2,5 cv	2,2 Kw	26,5 m ³ /h	280 mm	63 mm	23 kg	2 600 W	7,8 / 4,5	RS302053
	3 cv	2,2 Kw	30,7 m ³ /h	280 mm	63 mm	23 kg	2 600 W	7,8 / 4,5	RS30303

*at 8 m water column